

PT Network Camera

Quick Start Guide



User Manual

A

A1

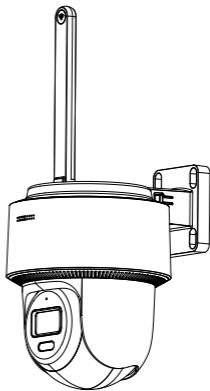
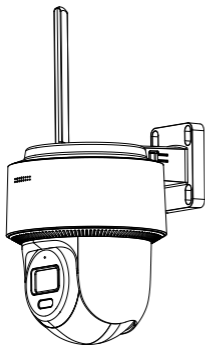
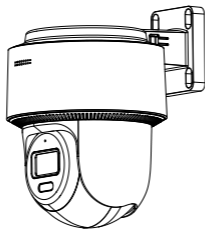

A2

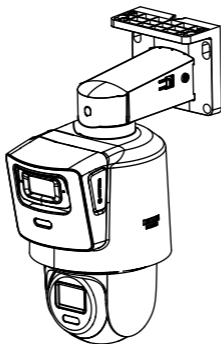

B

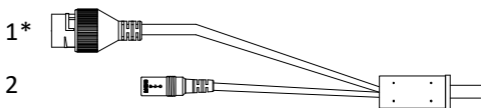

C

C1

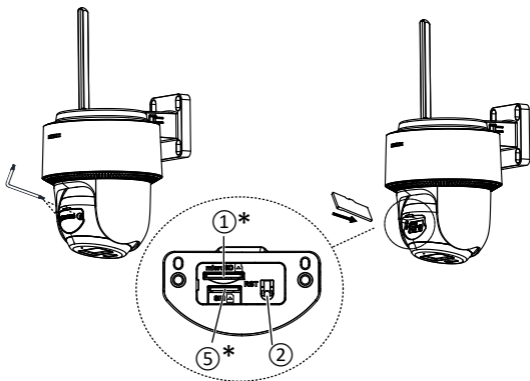
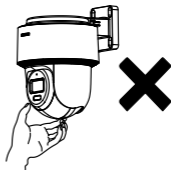
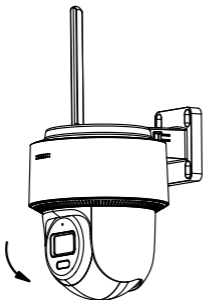

C2

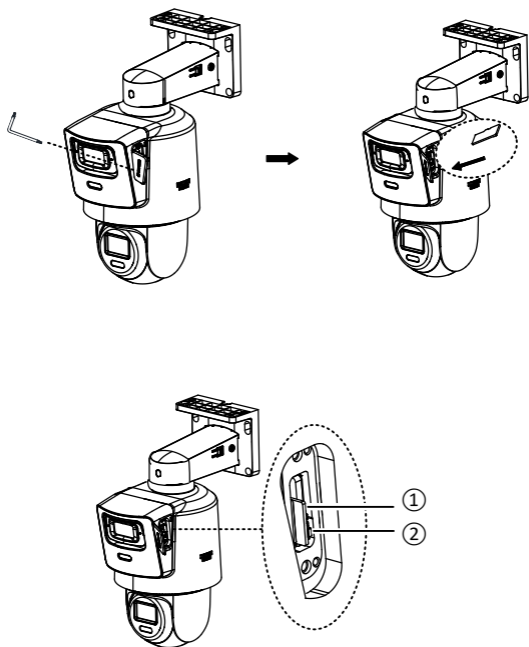

D

D1

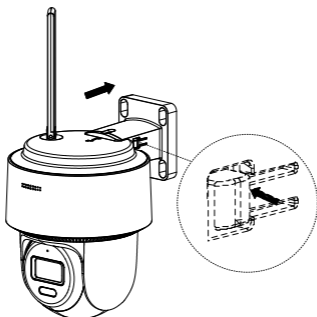

1

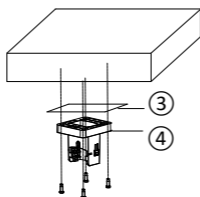

PA4 × 25

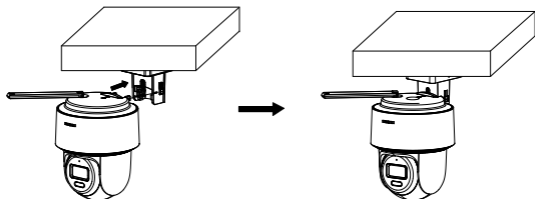

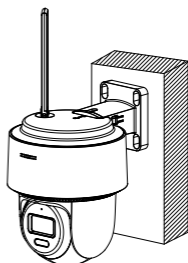
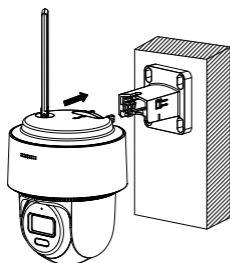
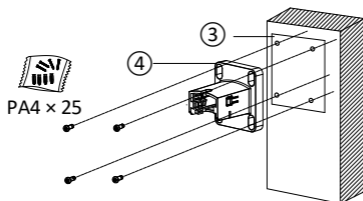

D2

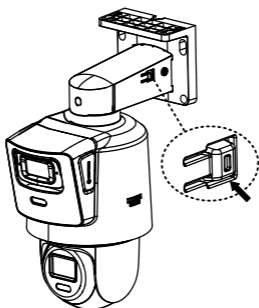

1

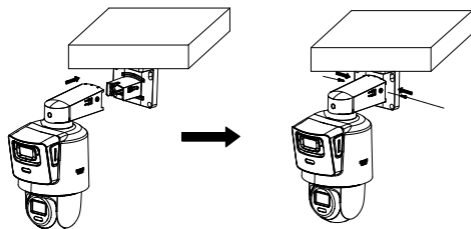
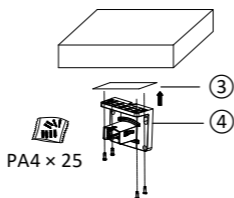

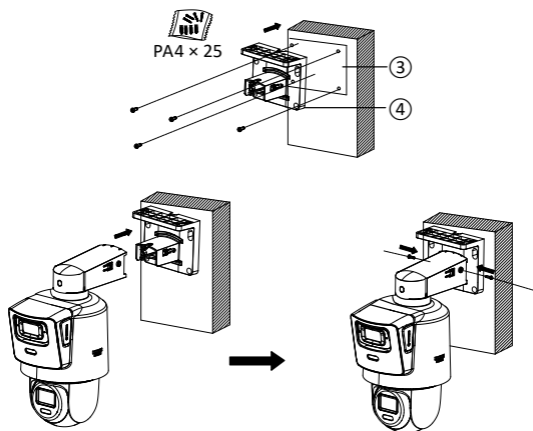

E

E1

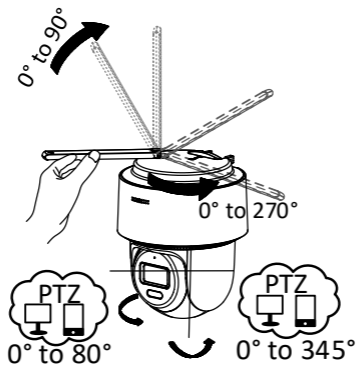

E2

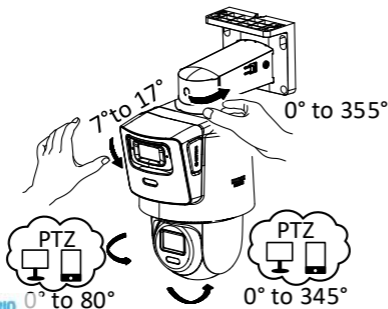

F

1

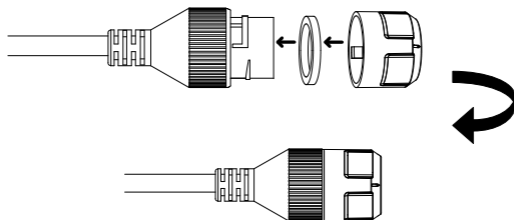

2

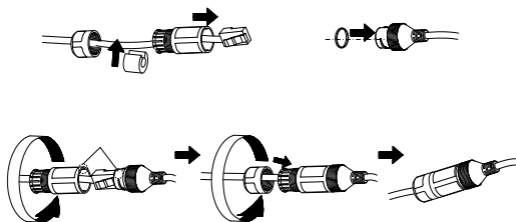

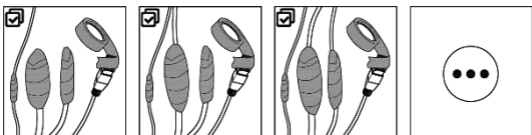
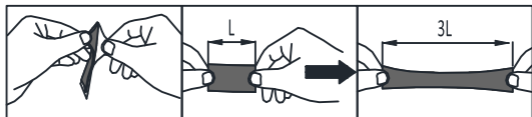

G



Symbols and Marks



- i. Not necessarily included accessory.
- ii. Variable accessory amount.
- iii. Skip this step if not required.

Camera Appearance (Page 1 – A)

- A1: Type 1 camera
- A2: Type 2 camera

Note:

Product appearance is for reference only and may differ from the actual product.

Cable Description (Page 2 – B)

1. Network interface:
 - For wired network cameras, it is for network transmission.
 - For wireless network cameras, it is for debugging only. Disconnect the interface after debugging.
2. Power input interface: Supports 12 VDC power supply.

Note:

- *The cable varies depending on camera models.*
- *Some wireless cameras do not support the network interface. Please refer to the product datasheet for details.*

Install the Memory Card or SIM Card (Page 3 – C)

C1 is for the type 1 camera, and C2 is for the type 2 camera.

- ① Memory card slot
- ② Reset button: Press reset button for about 10 s when the camera is powering on or rebooting to restore the default settings, including the username, password, IP address, port No., etc.
- ⑤ SIM card slot

Note:

The interface varies depending on camera models.

Install the Camera (Page 5 – D)

D1 is for the type 1 camera, and D2 is for the type 2 camera.

- ③ Drill template
- ④ Bracket
- Ceiling mounting (1)
- Wall mounting (2)

Adjust the Angle (Page 9 – E)

E1 is for the type 1 camera, and E2 is for the type 2 camera.

Note:

- *The adjustable angle varies depending on camera models and installation scenes. Please refer to the product datasheet for details.*
- *Only certain models of the type 1 camera support the antenna. Please refer to the actual product.*

Waterproof for Outdoor Installation (Page 10 – F)

1. Install the network cable waterproof jacket for wireless network cameras.

Note:

The network cable waterproof jacket is pre-installed for wireless network cameras. You can install it as illustrated once you remove it.

2. Install the network cable waterproof jacket for wired network cameras.
3. Use supplied waterproof tape to protect cable connectors and unused cables.

Activate and Access Network Camera (Page 11 – G)

Indicator Description

- **Wi-Fi Camera Indicator:**
 1. Solid red: The camera is powering up.
 2. Slow-flashing red: Wi-Fi network disconnects after Wi-Fi settings are completed.
 3. Slow flashing red and blue: The Wi-Fi signal is weak.
 4. Fast-flashing blue: The camera is ready for Wi-Fi connection, or Wi-Fi connection failed due to a wrong password.
 5. Slow-flashing blue: The camera is operating normally.
- **4G Camera Indicator:**
 1. Solid red: The camera is powering up.
 2. Slow-flashing red: 4G network connection failed.
 3. Slow flashing red and blue: The 4G signal is weak.
 4. Fast-flashing blue: The camera is ready for 4G network connection.
 5. Slow-flashing blue: The camera is operating normally.



UD41689B